

12-F1 Fuse/NX2 Snaplock

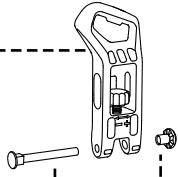

48-D2 Snaplock Mount Bolt+Nut Set
(for Nylon hiback)

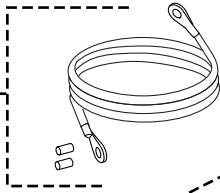

14-N1 FUSE Cable Set
(= Cable + Pins 27-H1)

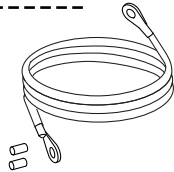

02-F3 Asym Nylon hiback Set
(= Hiback + EVA + Snaplock 12-F1+48-D2
+ C-bolt Set 28-R2)

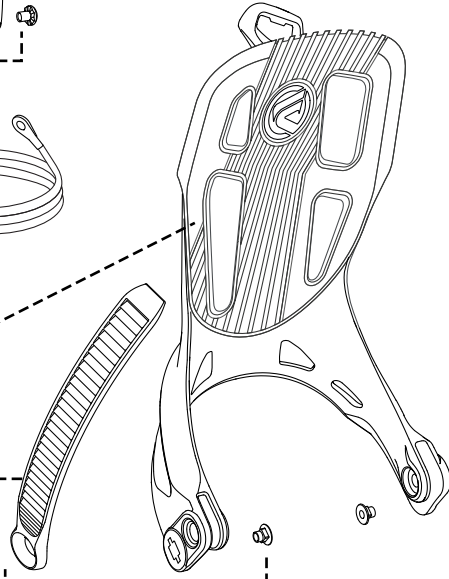

18-F1 LSR Pivot Ankle-ladder



38-B2 NX2/Fuse Ankle-ladder Pivot-mount Set
(= Screw 30-B1 (M5*9)
+ Pivot-washer 19-A2 + T-nut)

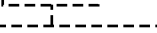

28-R2 Asym Uniback C-bolt Set
(= T-nut + Step-Screw (M5*14.8))

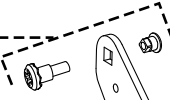

01-K2 Fuse-Series Baseplate Set (= Base + Wings
+ T-nuts 39-B1 + Screws (M5*11) 30-D1)

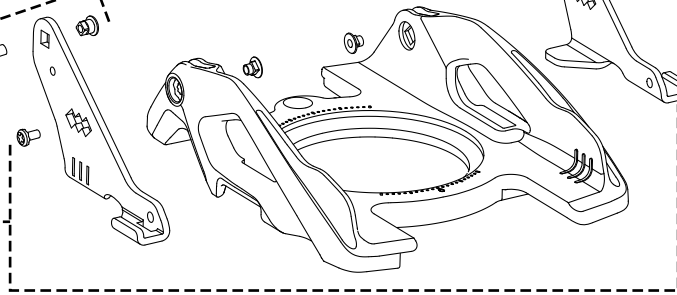

18-A1 LSR Toe-ladder w/ plug

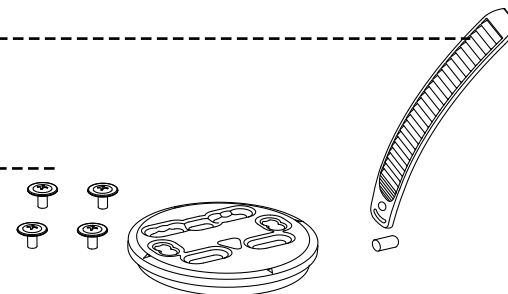

21-H2 Multi-Disk Mounting Set (= Disk
+ Mount-screws 42-G1 (M6*14.5))

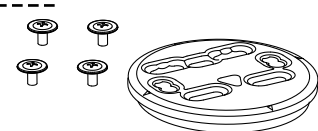

LSR Ankle-buckle w/ screw

41-H1

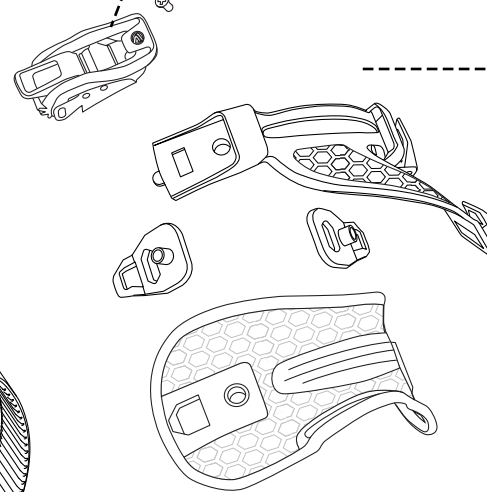

Hybrid ExoKush Set
(= ExoKush AnkleStrap +
Hybrid Ankle-Spine +
Insert-pods 11-L1 +
QS-latches)

11-K1

QuickSet Pivot Ankle-ladder

17-G1

EXO Buckles mounting-screw (M5*9)

24-C1

LSR Toe-buckle w/ screw

41-G2

Hexo Toecap w/ QS-latch

11-A1

QuickSet Y-Toeladder w/ plug

17-H2

Ladder-strap pin/plug

20-A1

Fuse BankBed footbed Set
(= BankBeds + Adj. Set 40-C2
Washer + Screws M5*12.5 + clips)

08-E1

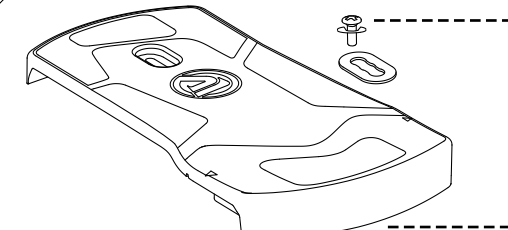

12-F1 Fuse/NX2 Snaplock

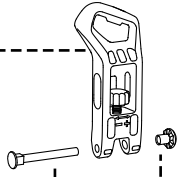

48-D2 Snaplock Mount Bolt+Nut Set
(for Nylon hiback)

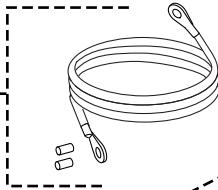

14-N1 FUSE Cable Set
(= Cable + Pins 27-H1)

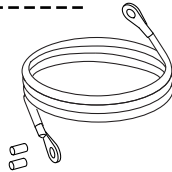

02-F4 Carbon Asym Nylon hiback Set
(= Hiback + EVA + Snaplock 12-F1+48-D2
+ C-bolt Set 28-R2)

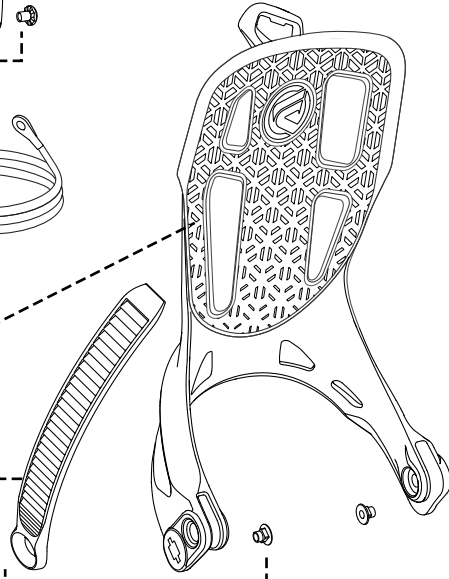

18-F1 LSR Pivot Ankle-ladder



38-B2 NX2/Fuse Ankle-ladder Pivot-mount Set
(= Screw 30-B1 (M5*9)
+ Pivot-washer 19-A2 + T-nut)



28-R2 Asym Uniback C-bolt Set
(= T-nut + Step-Screw (M5*14.8))

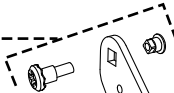

01-K2 Fuse-Series Baseplate Set (= Base + Wings
+ T-nuts 39-B1 + Screws (M5*11) 30-D1)

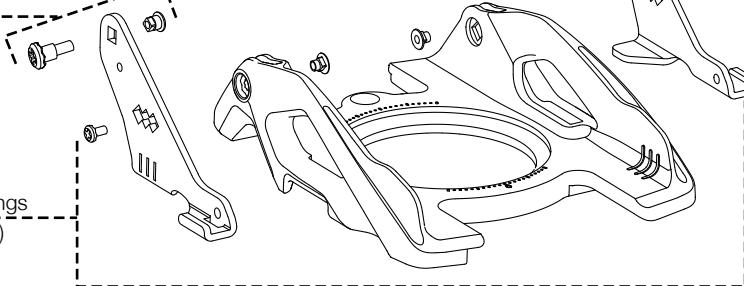

18-A1 LSR Toe-ladder w/ plug

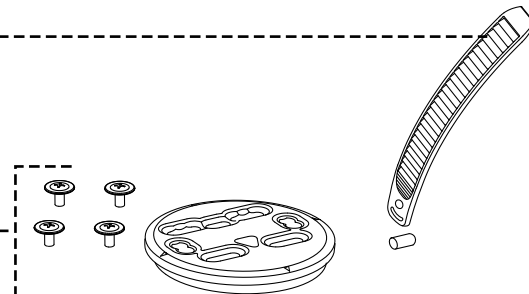

21-H2 Multi-Disk Mounting Set (= Disk
+ Mount-screws 42-G1 (M6*14.5))

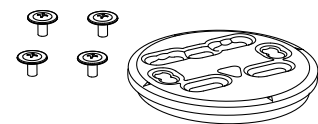

LSR Ankle-buckle w/ screw

41-H1

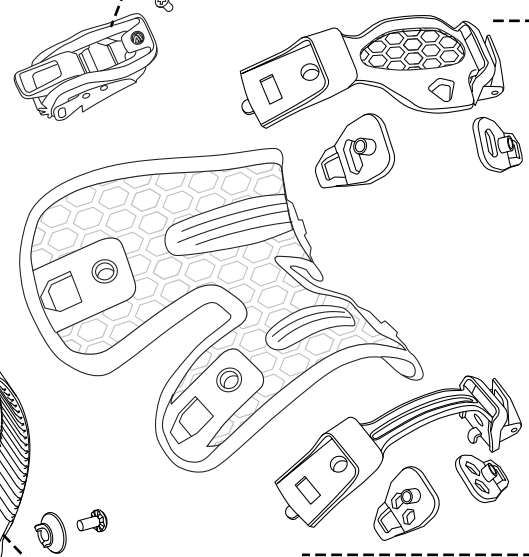

11-G1 Fusion ExoKush Set
(= ExoKush Strap +
FusionAnkle-Spine +
ToeSpine +
Insert-pods 11-L1 +
QS-latches)

LSR Toe-buckle w/ screw

41-G2

EXO Buckles mounting-screw (M5*9)

24-C1

QuickSet Pivot Ankle-ladder

17-G1

QuickSet Toe-ladder w/ plug

17-D1

Ladder-strap pin/plug

20-A1

08-E1 Fuse BankBed footbed Set
(= BankBeds + Adj. Set 40-C2
Washer + Screws M5*12.5 + clips)

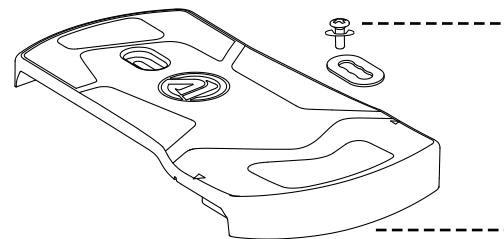

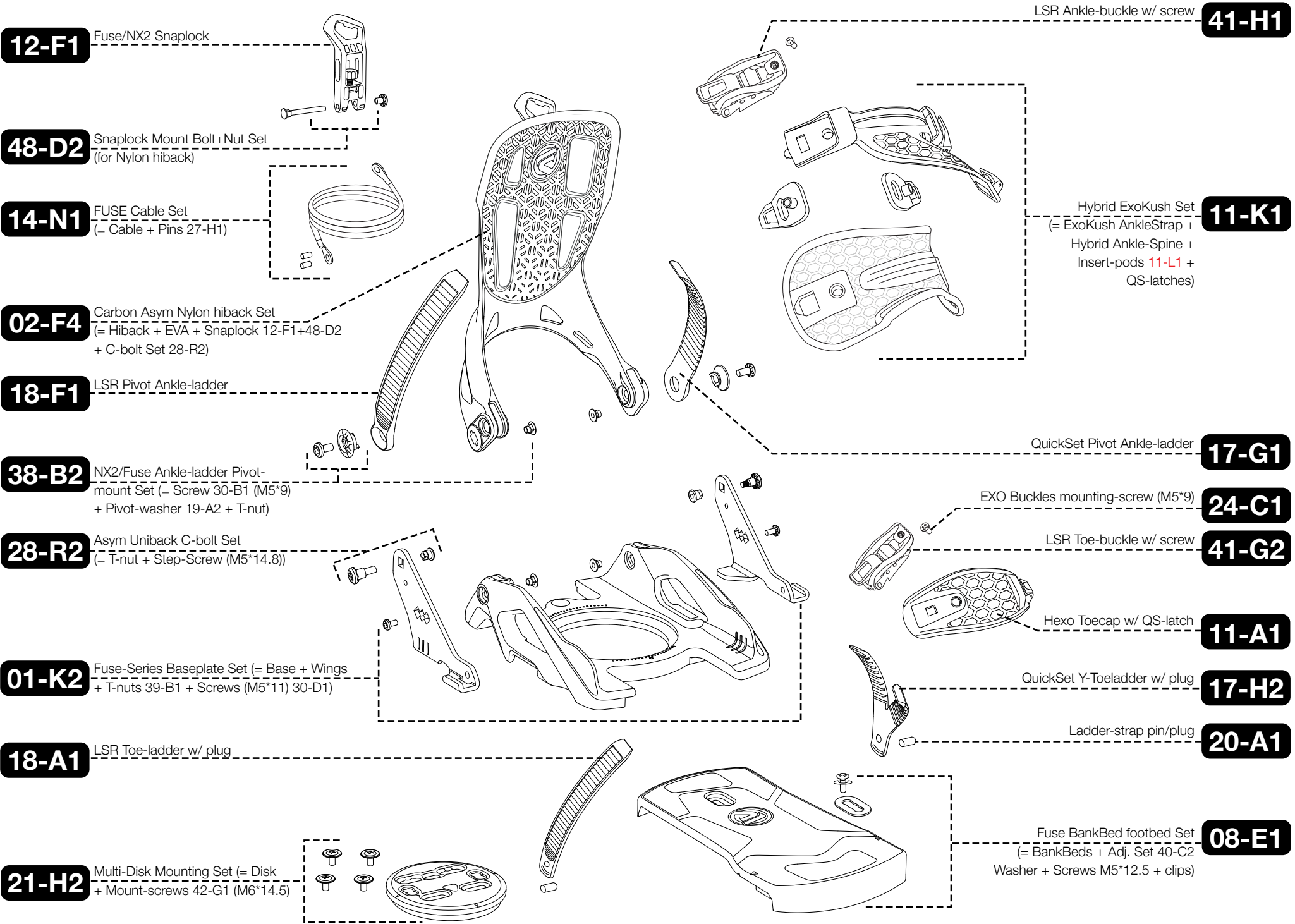

12-F1 Fuse/NX2 Snaplock

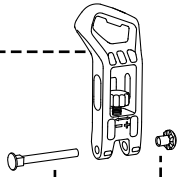

48-D2 Snaplock Mount Bolt+Nut Set
(for Nylon hiback)

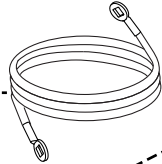

14-O1 NX2-CX Cable



02-F3 Asym hiback Set
(= Hiback + EVA + Snaplock 12-F1+48-D2
+ C-bolt Set 28-R2)

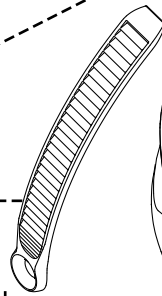

18-F1 LSR Pivot Ankle-ladder



38-B2 NX2/Fuse Ankle-ladder Pivot-mount Set
(= Screw 30-B1 (M5*9)
+ Pivot-washer 19-A2 + T-nut)



28-R2 Asym Uniback C-bolt Set
(= T-nut + Step-Screw (M5*14.8))



27-G2 NX2-Cable Mount-Set
(= Cover + Washers + Tnut + Screw 30-B1 (M5*9))



18-B1 LSR Toe-ladder



34-C2 NX2 Toeladder Mount-Set
(= Cover + T-nut + Screw 30-B1 (M5*9))



21-G3 Multi-Disk Alu Mounting Set (= Disk
+ Mount-screws 42F2 (M6*13))

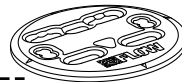

LSR Ankle-buckle w/ screw

41-H1

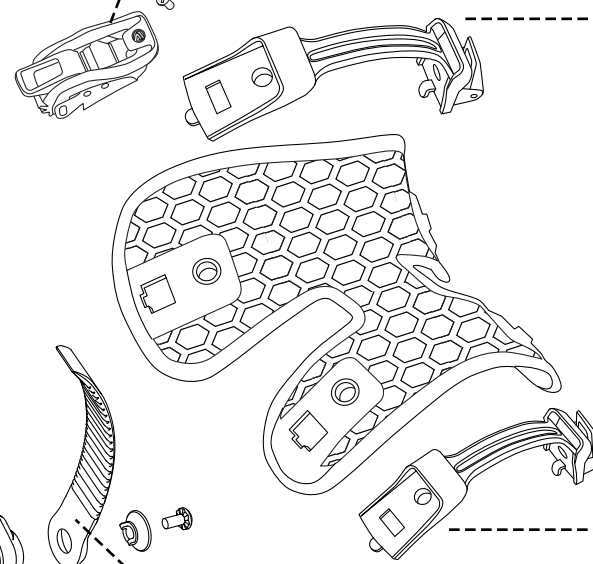

Fusion ExoFrame Set
(= ExoFrame + AnkleSpine
+ ToeSpine + QS-latches)

11-F1

LSR Toe-buckle w/ screw

41-G2

EXO Buckles mounting-screw (M5*9)

24-C1

QuickSet Pivot Ankle-ladder

17-G1

QuickSet Toe-ladder

17-E1

NX2-TM Series Baseplate Set
(= Baseplate + OC-Kush Basepad)

01-R1

NX2 Slip-N-Grip BankBed
footbed Set

08-G1

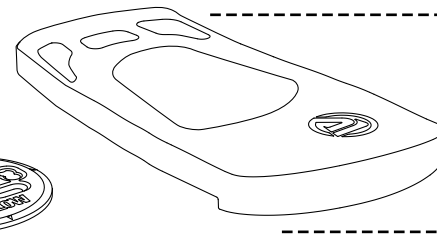

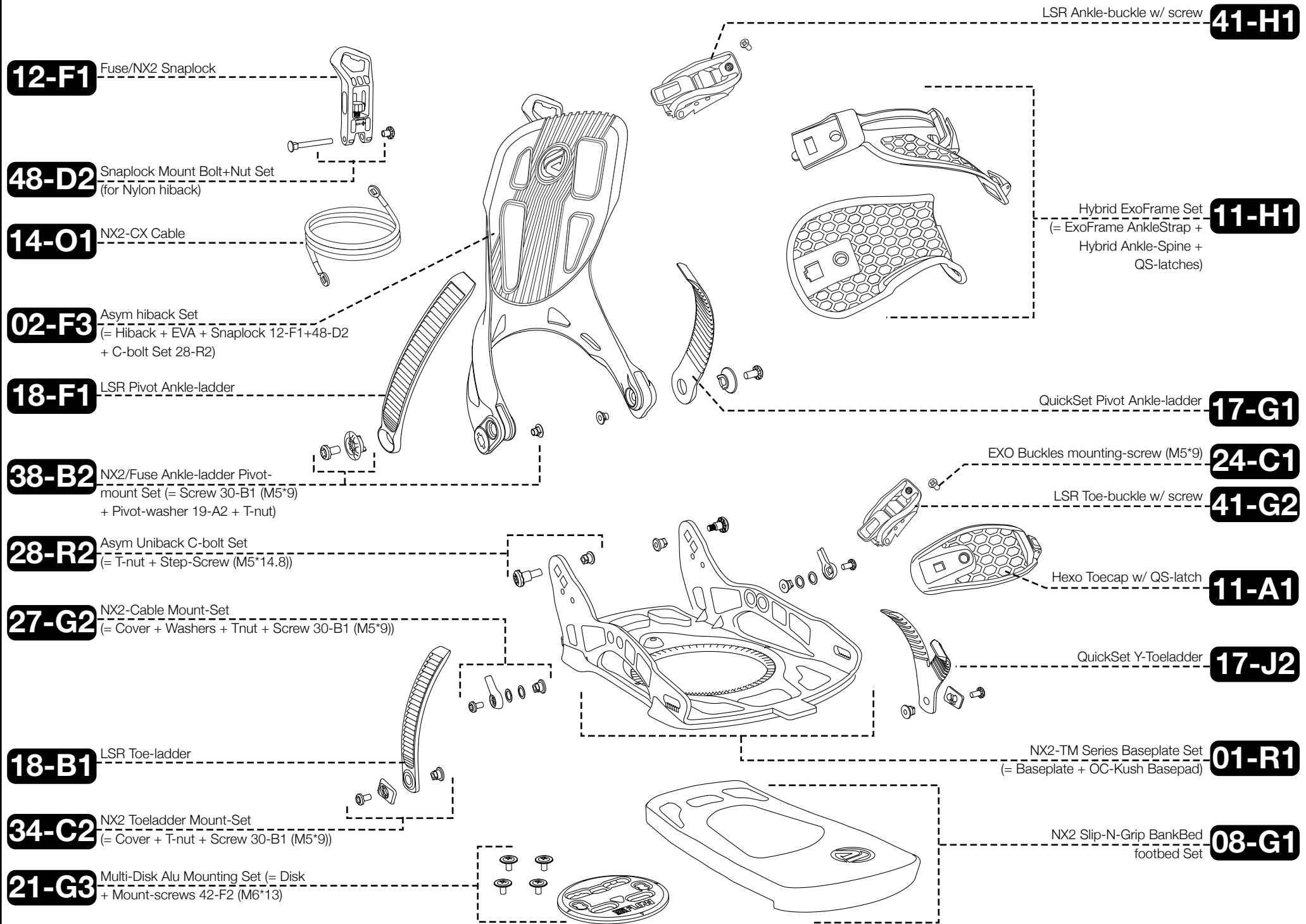

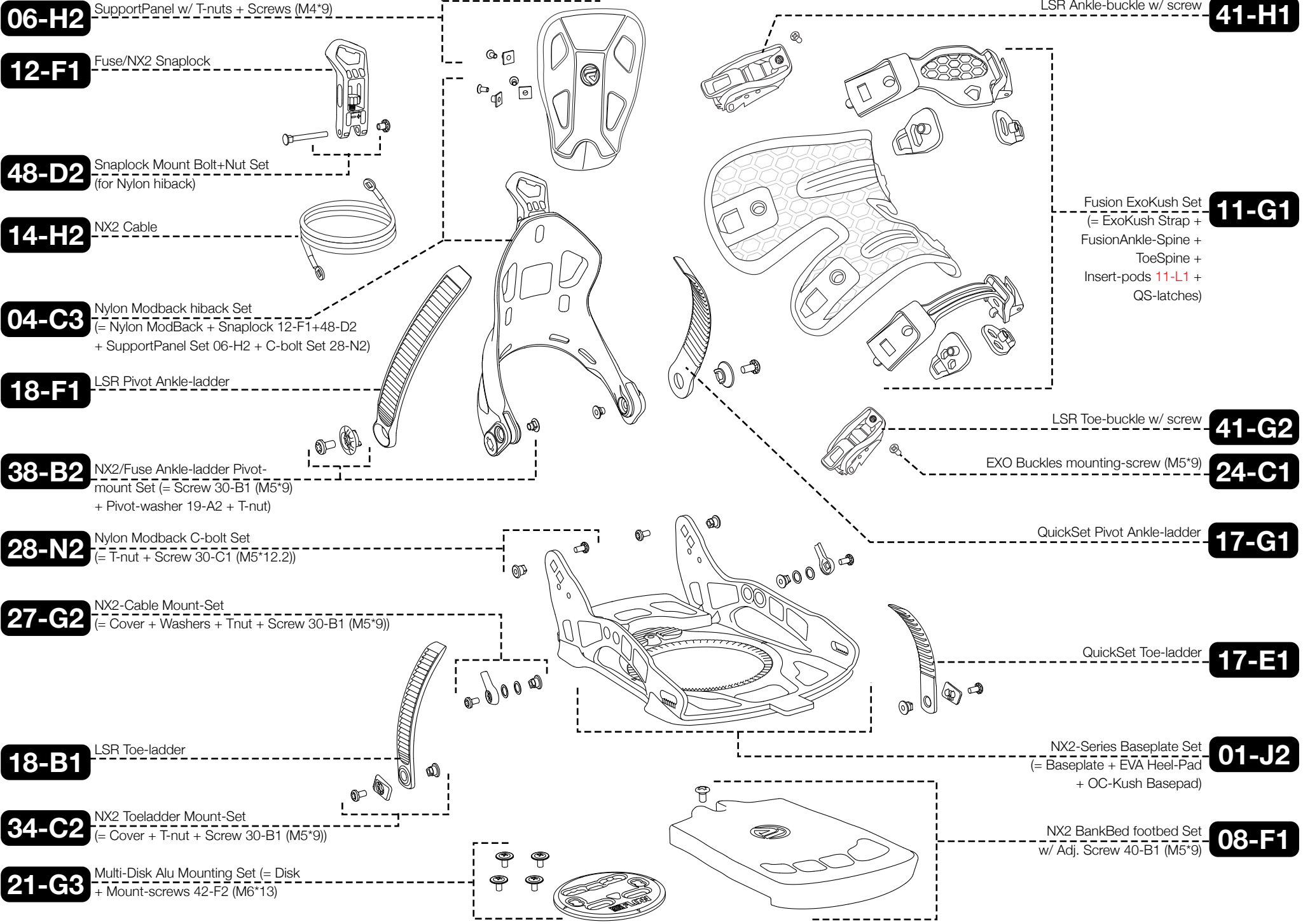

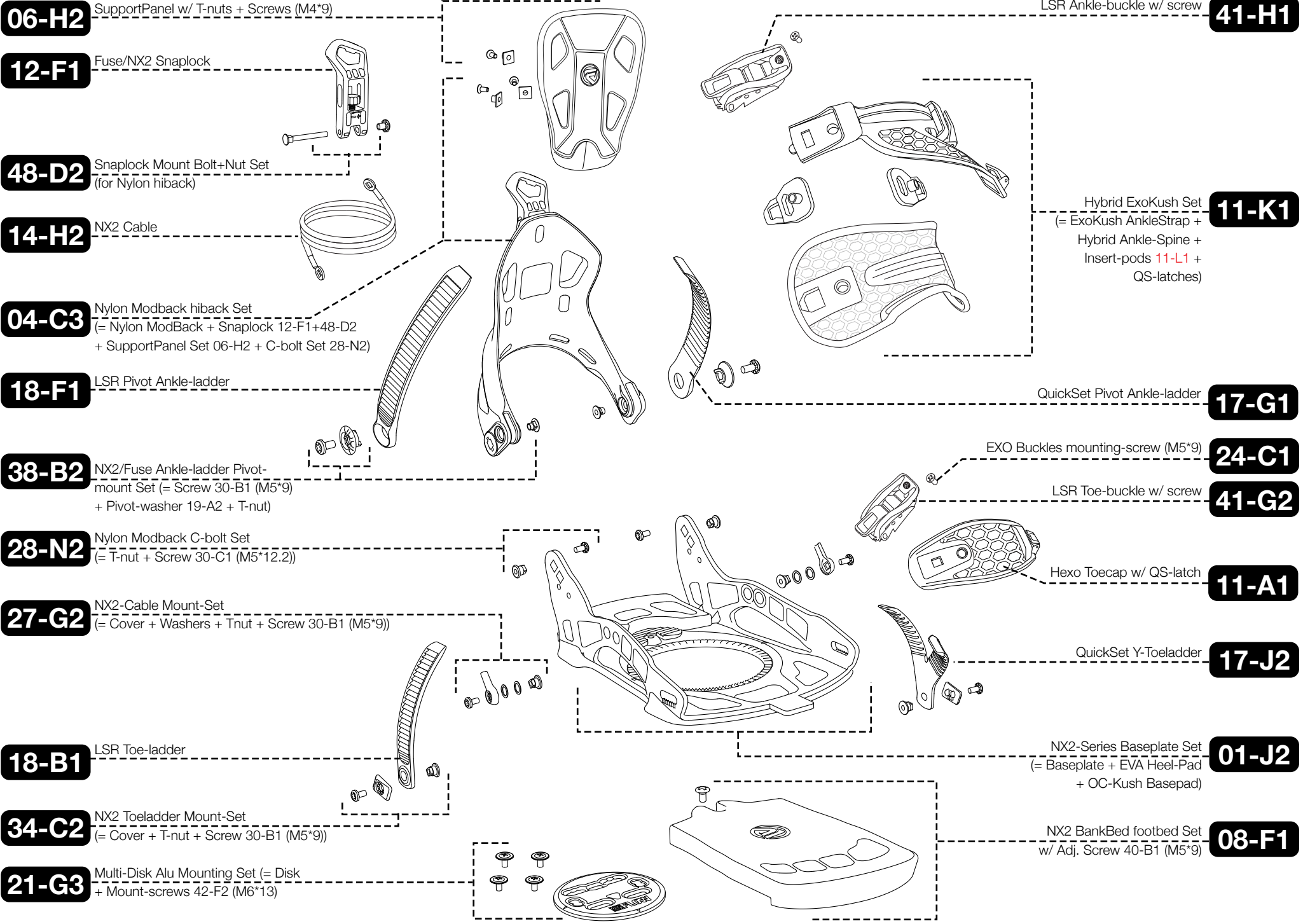

06-H2 SupportPanel w/ T-nuts + Screws (M4*9)

12-F1 Fuse/NX2 Snaplock

48-D2 Snaplock Mount Bolt+Nut Set (for Nylon hiback)

14-H2 NX2 Cable

04-C3 Nylon Modback hiback Set (= Nylon ModBack + Snaplock 12-F1+48-D2 + SupportPanel Set 06-H2 + C-bolt Set 28-N2)

18-F1 LSR Pivot Ankle-ladder

38-B2 NX2/Fuse Ankle-ladder Pivot-mount Set (= Screw 30-B1 (M5*9) + Pivot-washer 19-A2 + T-nut)

28-N2 Nylon Modback C-bolt Set (= T-nut + Screw 30-C1 (M5*12.2))

27-G2 NX2-Cable Mount-Set (= Cover + Washers + Tnut + Screw 30-B1 (M5*9))

18-B1 LSR Toe-ladder

34-C2 NX2 Toeladder Mount-Set (= Cover + T-nut + Screw 30-B1 (M5*9))

21-G3 Multi-Disk Alu Mounting Set (= Disk + Mount-screws 42-F2 (M6*13))

LSR Ankle-buckle w/ screw **41-H1**

Hybrid ExoKush Set **11-K1**
 (= ExoKush AnkleStrap + Hybrid Ankle-Spine + Insert-pods **11-L1** + QS-latches)

QuickSet Pivot Ankle-ladder **17-G1**

EXO Buckles mounting-screw (M5*9) **24-C1**

LSR Toe-buckle w/ screw **41-G2**

Hexo Toecap w/ QS-latch **11-A1**

QuickSet Y-Toeladder **17-J2**

NX2-Series Baseplate Set **01-J2**
 (= Baseplate + EVA Heel-Pad + OC-Kush Basepad)

NX2 BankBed footbed Set **08-F1**
 w/ Adj. Screw 40-B1 (M5*9)

12-F1 Fuse/NX2 Snaplock

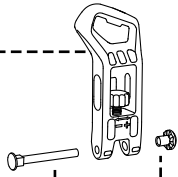

48-D2 Snaplock Mount Bolt+Nut Set
(for Nylon hiback)

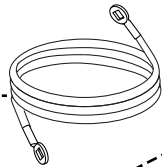

14-O1 NX2-CX Cable

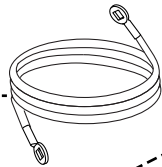

02-F4 Carbon Asym hiback Set
(= Hiback + EVA + Snaplock 12-F1+48-D2
+ C-bolt Set 28-R2)

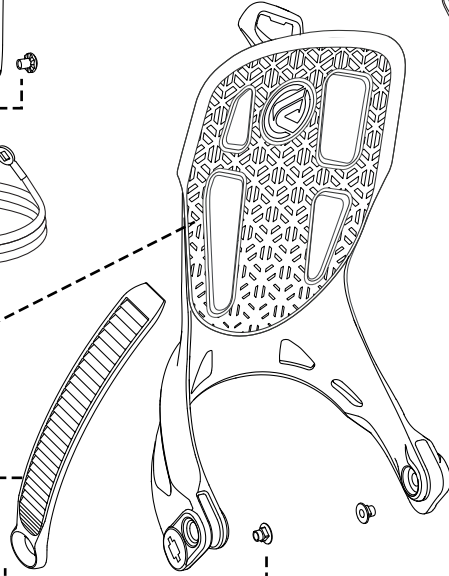

18-F1 LSR Pivot Ankle-ladder



38-B2 NX2/Fuse Ankle-ladder Pivot-mount Set (= Screw 30-B1 (M5*9)
+ Pivot-washer 19-A2 + T-nut)



28-R2 Asym Uniback C-bolt Set
(= T-nut + Step-Screw (M5*14.8))



27-G2 NX2-Cable Mount-Set
(= Cover + Washers + Tnut + Screw 30-B1 (M5*9))



18-B1 LSR Toe-ladder



34-C2 NX2 Toeladder Mount-Set
(= Cover + T-nut + Screw 30-B1 (M5*9))



21-G3 Multi-Disk Alu Mounting Set (= Disk
+ Mount-screws 42-F2 (M6*13))

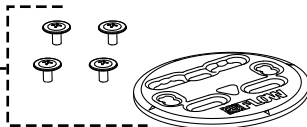

LSR Ankle-buckle w/ screw

41-H1

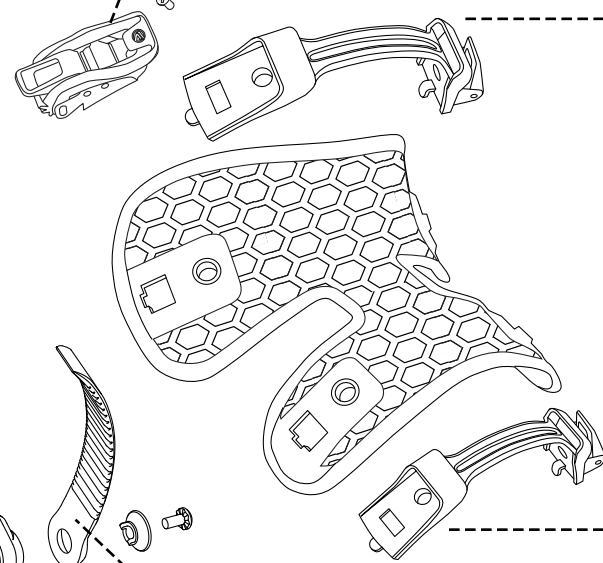

Fusion ExoFrame Set
(= ExoFrame + AnkleSpine
+ ToeSpine + QS-latches)

11-F1

LSR Toe-buckle w/ screw

41-G2

EXO Buckles mounting-screw (M5*9)

24-C1

QuickSet Pivot Ankle-ladder

17-G1

QuickSet Toe-ladder

17-E1

NX2-TM Series Baseplate Set
(= Baseplate + OC-Kush Basepad)

01-R1

NX2-Carbon Slip-N-Grip BankBed
footbed Set

08-H1

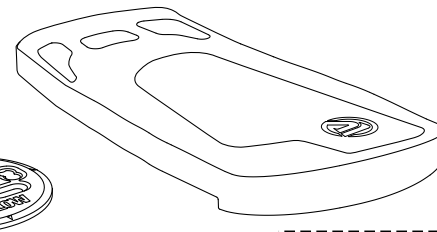

12-F1 Fuse/NX2 Snaplock

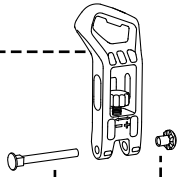

48-D2 Snaplock Mount Bolt+Nut Set
(for Nylon hiback)

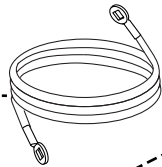

14-O1 NX2-CX Cable

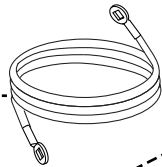

02-F4 Carbon Asym hiback Set
(= Hiback + EVA + Snaplock 12-F1+48-D2
+ C-bolt Set 28-R2)

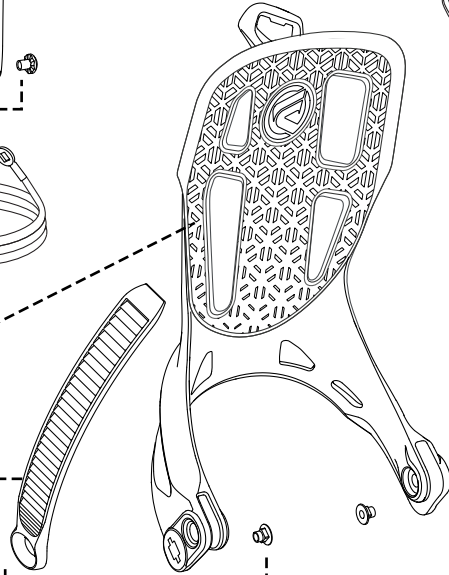

18-F1 LSR Pivot Ankle-ladder

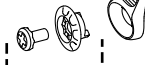

38-B2 NX2/Fuse Ankle-ladder Pivot-mount Set
(= Screw 30-B1 (M5*9)
+ Pivot-washer 19-A2 + T-nut)

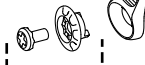

28-R2 Asym Uniback C-bolt Set
(= T-nut + Step-Screw (M5*14.8))



27-G2 NX2-Cable Mount-Set
(= Cover + Washers + Tnut + Screw 30-B1 (M5*9))



18-B1 LSR Toe-ladder



34-C2 NX2 Toeladder Mount-Set
(= Cover + T-nut + Screw 30-B1 (M5*9))



21-G3 Multi-Disk Alu Mounting Set (= Disk
+ Mount-screws 42-F2 (M6*13))

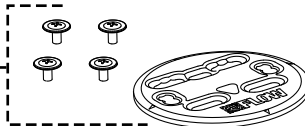

LSR Ankle-buckle w/ screw

41-H1

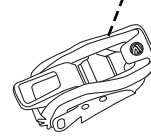

Hybrid ExoFrame Set
(= ExoFrame AnkleStrap +
Hybrid Ankle-Spine +
QS-latches)

11-H1

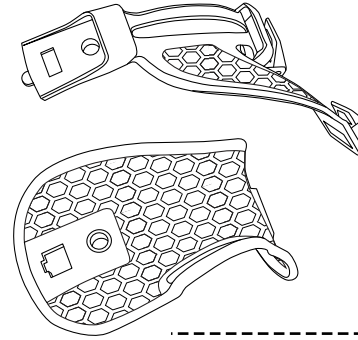

QuickSet Pivot Ankle-ladder

17-G1



EXO Buckles mounting-screw (M5*9)

24-C1

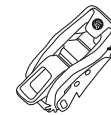

LSR Toe-buckle w/ screw

41-G2

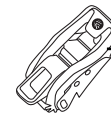

Hexo Toecap w/ QS-latch

11-A1

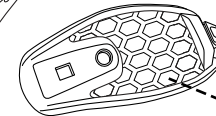

QuickSet Y-Toeladder

17-J2

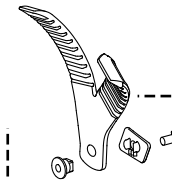

NX2-TM Series Baseplate Set
(= Baseplate + OC-Kush Basepad)

01-R1

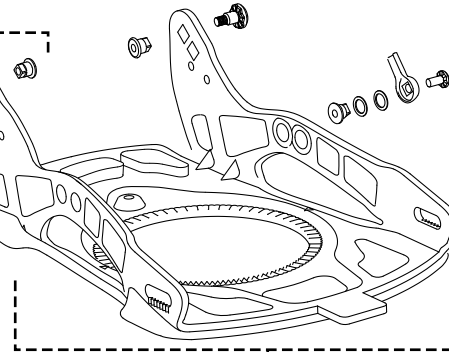

NX2-Carbon Slip-N-Grip BankBed
footbed Set

08-H1

